

Section II.

TM 9-2320-280-24P-1

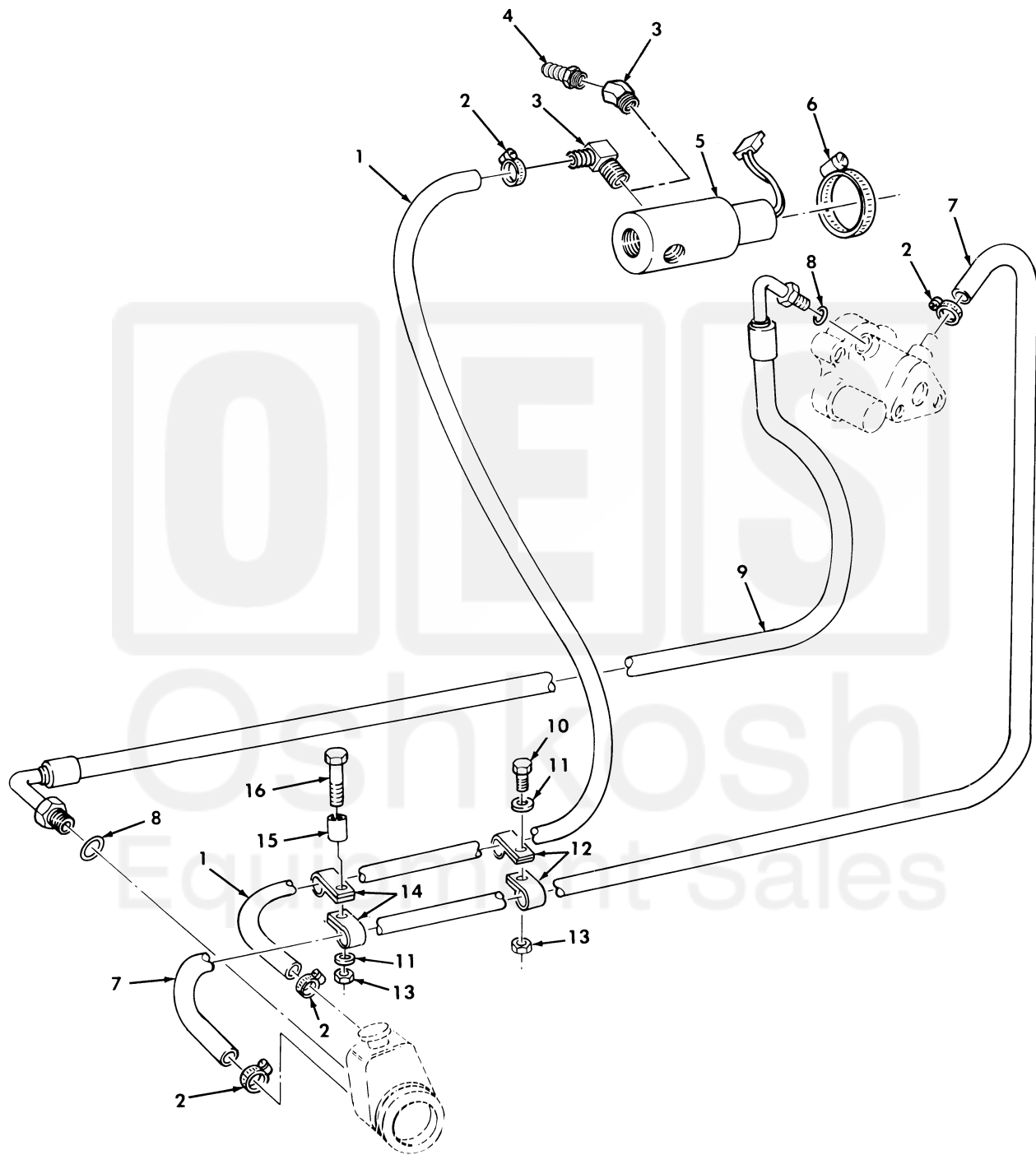

Figure 177. Power Steering and Hydro-Booster Hydraulic Lines and Fittings.

SECTION II			TM9-2320-280-24P			
(1)	(2)	(3)	(4)	(5)	(6)	(7)
ITEM NO	SMR CODE	NSN	CAGEC	PART NUMBER	DESCRIPTION AND USABLE ON CODES(UC)	QTY
GROUP 1411 HOSES,LINES,FITTINGS						
FIG. 177 POWER STEERING AND HYDRO-BOOSTER HYDRAULIC LINES AND FITTINGS						
1	MOZZ		34623	5590023	HOSE MAKE FROM HOSE,P/N 6490610019, 23 INCHES LONG.....	1
2	PAZZ	4730011188278	76599	MMF4-SS	CLAMP,HOSE.....	4
3	PAZZ	4730007890951	79470	110-03604	ELBOW,PIPE TO TUBE.....	1
UC:AVY,A11,A13,A14,A20,A24,A25,A26,A27,B16,B17,B18,HVY,H11,H13,H14,H16,H17,H18,H20,H21,H24,H25,H26,H27,H28,MMM						
3	PAZZ	4730009115707	21450	454097	ELBOW,PIPE TO TUBE.....	1
UC:A15,BVY,B15,B20,B24,B25,C17,H15,NNN						
4	PAZZ		19207	12460305	ADAPTER,STRAIGHT,P.....	1
UC:A15,BVY,B15,B20,B24,B25,C17,H15,NNN						
5	PAZZ	4810011925817	51376	1059-06607-01	VALVE,SOLENOID.....	1
6	PAZZ	4730002043491	66295	C32P	CLAMP,HOSE.....	1
7	MOZZ		34623	5590024	HOSE,NONMETALLIC MAKE FROM HOSE,P/N 6490610019,41 INCHES LONG.....	1
8	PAZZ	5331005806586	02697	2-011N674-70	O-RING.....	2
9	PAZZ	4720012123531	19207	12338957	HOSE ASSEMBLY,NONME.....	1
10	PAZZ	5305000687837	80204	B1821BH025C063N	SCREW,CAP,HEXAGON H 1/4-20 X 5/8...	1
11	PAZZ	5310008094058	96906	MS27183-10	WASHER,FLAT 1/4.....	2
12	PAZZ	5340007255280	96906	MS21333-125	CLAMP,LOOP.....	2
13	PAZZ	5310000614650	96906	MS51943-31	NUT,SELF-LOCKING,HE 1/4-20.....	2
14	PAZZ	5340011539425	75272	COV-1109Z1	CLAMP,LOOP.....	2
15	PAZZ	5365012115094	19207	12340486	SPACER,SLEEVE.....	1
16	PAZZ	5306012542359	34623	5593024	BOLT,MACHINE 1/4-20 X 2.50.....	1

END OF FIGURE

OSHKOSH
Equipment Sales